

CABINET ASSEMBLY

MODEL: JMP-7230

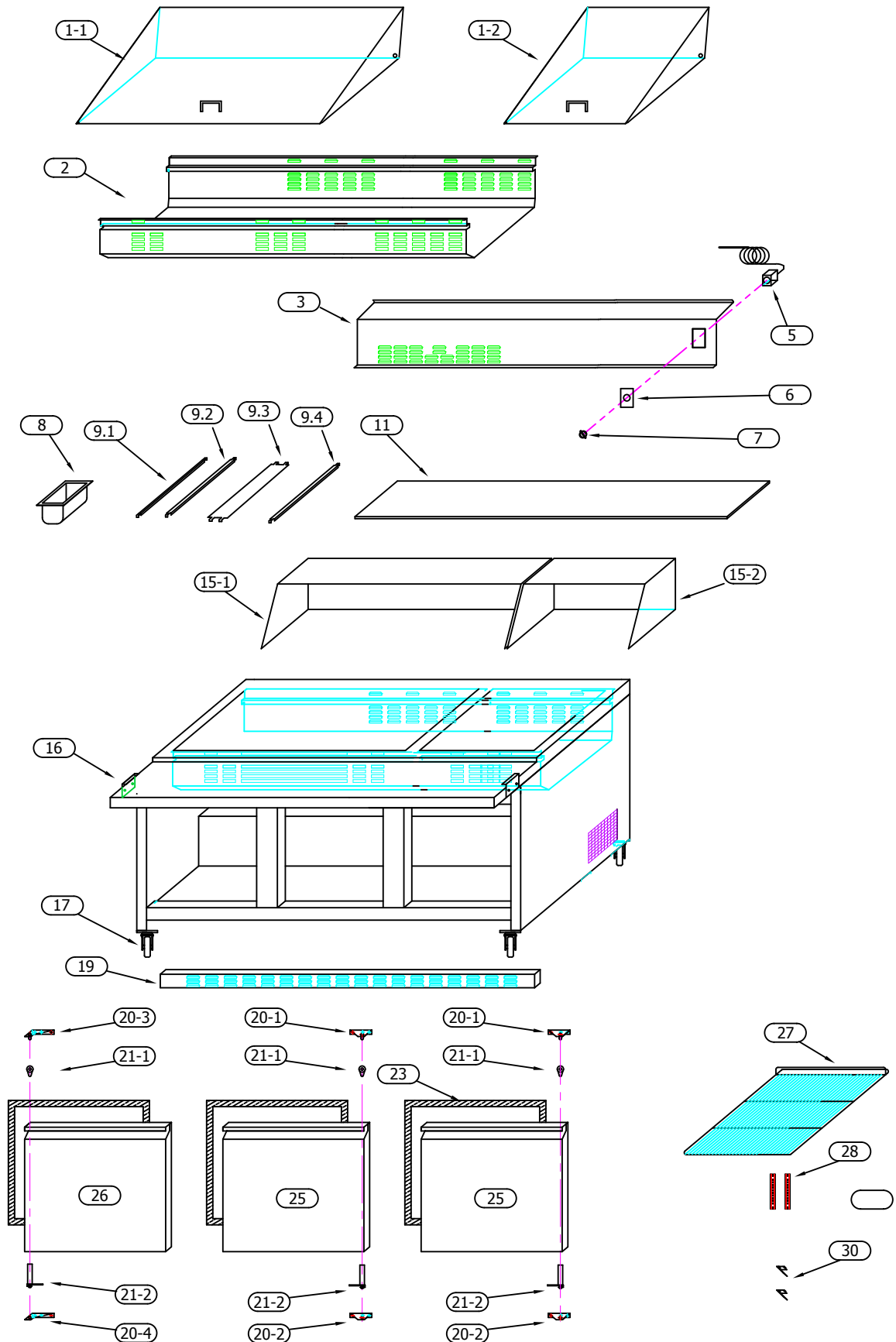

CABINET ASSEMBLY

MODEL: JMP-7230

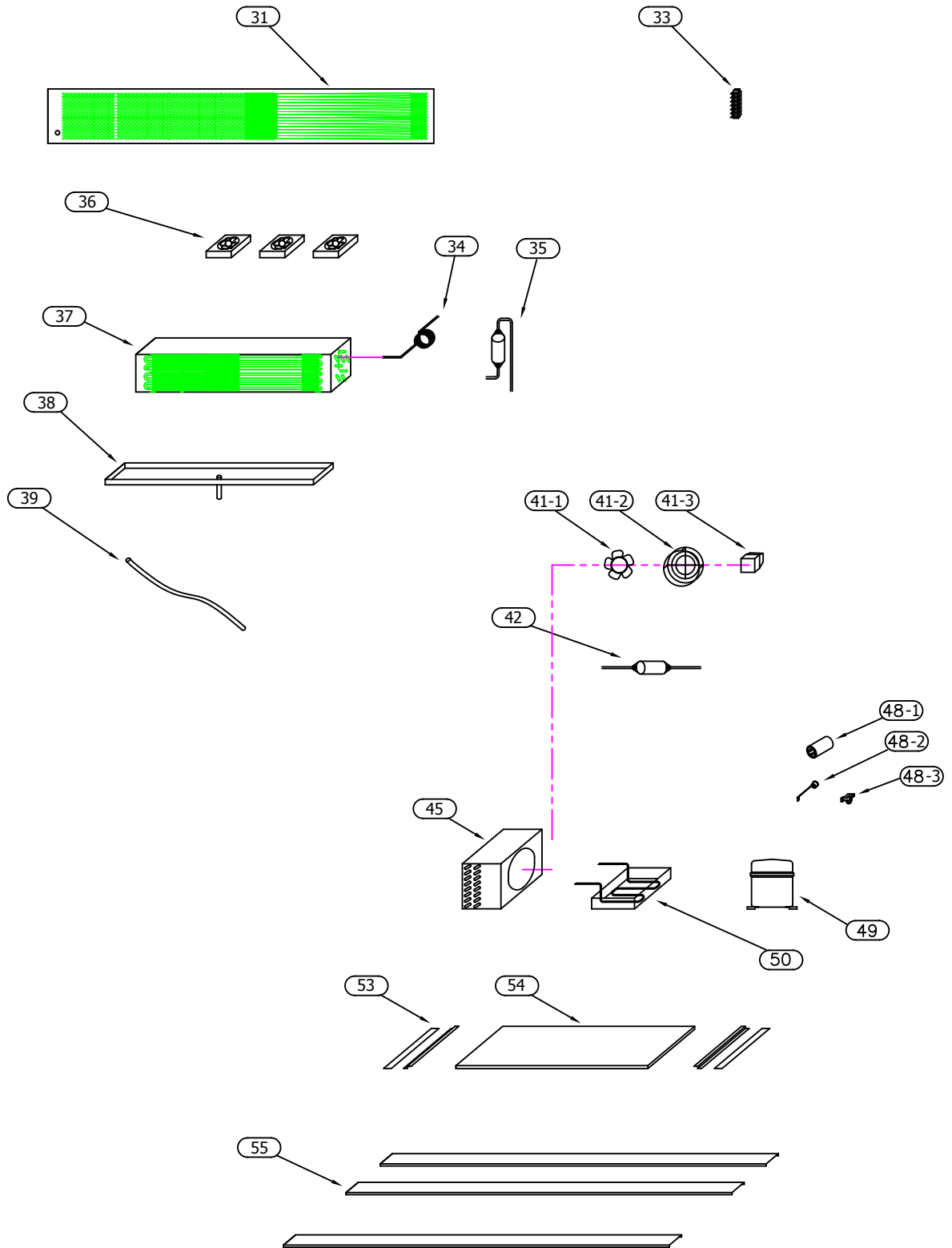

CABINET ASSEMBLY LIST

MODEL: JMP-7230

08/08

No.	Q'ty	Part No. (Use when ordering)	Description	List Price
1-1	1	457 4232	Top panel, JMP-4818, JMP-7230, 46" wide, (coniment lid)	\$350.00
1-2	1	457 4231	Top panel, JMP-2712, JMP-7230, 25.5" wide, (coniment lid)	\$300.00
2	1	457 5701	Panel, food catch, below pans, JMP-7230	\$300.00
3	1	457 1509	Evaporator coil cover, Ascend 72" prep units, inside back panel	\$300.00
5	1	457 7201	Temperature controller, t-stat, Ranco	\$90.00
6	1	457 7402	Temperature control (t-stat) metal cover	\$15.00
7	1	457 7401	Temperature control (t-stat) knob	\$10.00
8	30	457 5801	Food pan, polycarbonate, 1/6 size, 4" deep, clear	\$15.00
9.1	1	457 5815	Pan divider, 1.5" wide, left edge only, JMP-7230, each	\$8.00
9.2	7	457 5808	Pan divider, 1" wide, fits middle sections, JMP units, each	\$8.00
9.3	1	457 5810	Pan divider, 5" wide, fits middle section, JMP units, each	\$12.00
9.4	1	457 5807	Pan divider, .5" wide, fits on edges only, JMP units, each	\$8.00
11	1	457 4031	Cutting board, 1/2" x 10" x 71.75"	\$150.00
15-1	1	457 4523	Hood, JMP-4818, JMP-7230, 46" wide	\$400.00
15-2	1	457 4522	Hood, JMP-2712, JMP-7230 unit, 25.5" wide	\$200.00
16	2	457 4015	Bracket, holds cutting board, Ascend preps	\$7.00
17	2	457 4801	Caster, 5", stem, no lock	\$25.00
17	2	457 4802	Caster, 5", stem, with lock	\$30.00
18	1	457 4505	Front bottom vent grill, 72"	\$250.00
20-1	2	457 4301	Hinge, prep & u/c, top right hinge, Ascend units	\$20.00
20-2	2	457 4303	Hinge, prep & u/c, bottom right hinge, Ascend units	\$20.00
20-3	1	457 4304	Hinge, prep & u/c, top left hinge, Ascend units	\$20.00
20-4	1	457 4306	Hinge, prep & u/c, bottom left hinge, Ascend units	\$20.00
21-1	3	457 4121	Plastic / nylon circular bushing insert, top of door	\$5.00
21-2	3	457 4400	Tensioner, bottom of door, prep & u/c	\$38.00
23	3	457 4200	Door gasket, Ascend 48 and 72" prep units	\$60.00
25	2	457 4113	Door, 48 and 72" wide models, right hinge	\$200.00
26	1	457 4114	Door, 48 and 72" wide models, left hinge	\$200.00
27	2	457 5211	Vinyl coated wire shelf, Ascend 48 & 72" prep & u/c, 21.25" x 17.25"	\$60.00
27	1	457 5210	Vinyl coated wire shelf, middle, Ascend 72" prep & u/c, 22.75" x 17.25"	\$60.00
28	12	457 5104	Pilaster, Ascend prep units	\$15.00
30	12	457 5300	Shelf clip (each)	\$5.00
31	1	457 4514	Bottom back mesh cover, Ascend 72" prep units	\$175.00
33	1	457 6302	Power supply terminal block, 600V, 30A, 4 circuit	\$30.00
34	1	457 3521	Cap tube. 0.052 ID, 55 in.	\$18.00
35	1	457 1701	Accumulator, copper, evap coil	\$25.00
36	3	457 1204	Evaporator fan motor w/blade, 115V	\$142.00
36		457 1210	Evaporator fan motor w/blade, NMB 120V/1PH/14W	\$142.00
37	1	457 1114	Evaporator coil for 60 and 72" Ascend preps, 5d x 36.25w (4/5)	\$400.00
38	1	457 1601	Drain pan, evaporator, 72" Ascend prep	\$100.00

CABINET ASSEMBLY LIST

MODEL: JMP-7230

08/08

No.	Q'ty	Part No. (Use when ordering)		Description	List Price
39	1	457	2501	Evaporator drain pan tube, flexible plastic	\$15.00
41-1	1	457	2401	Condenser fan blade, 5B, 7.75" diameter	\$20.00
41-2	1	457	2302	Condenser fan blade cover / guard, 9" dia.	\$20.00
41-3	1	457	2207	Condenser fan motor, 115V	\$90.00
42	1	457	3601	Filter drier, copper spun	\$20.00
45	1	457	2109	Condenser coil, 60",72" preps, 9x5.5x8 (8x6)	\$300.00
48-1	1	906	3305	189-227UF (6213)	\$40.00
48-2	1	906	3205	Relay for Aspera T6213Z	\$30.00
48-3	1	906	3405	Overload for T6213Z, 1/2 HP	\$40.00
49	1	906	3105	Compressor Aspera, 1/2 HP R-134a 115V	\$400.00
50				Condensate pan, w/ hot gas loop, Ascend 72" prep units	
53	2	457	4320	System deck rail, left or right, Ascend prep & u/c	\$15.00
54	1	457	4322	Deck, system, Ascend 60 & 72" prep & u/c	\$80.00
55	2	457	4316	Cabinet support, 72" Acend prep & u/c	\$100.00