

# CABINET ASSEMBLY

MODEL: JMP-4818

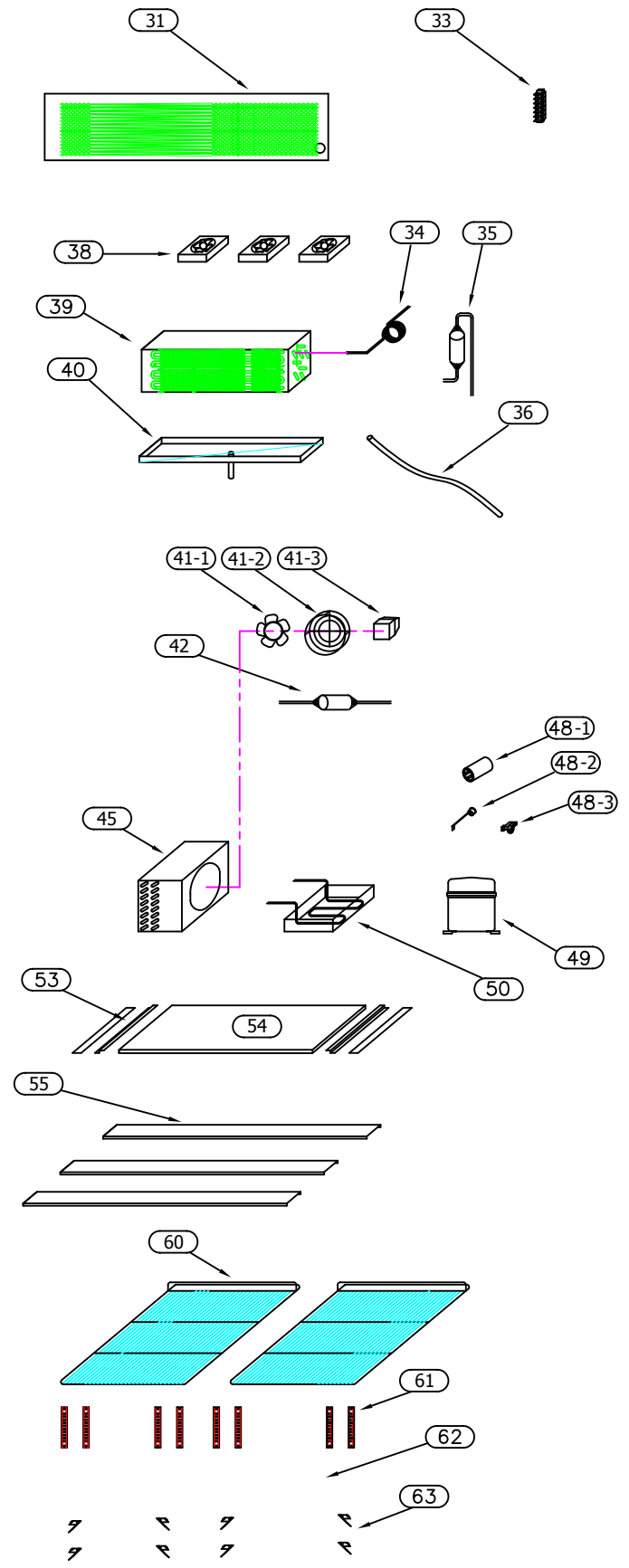
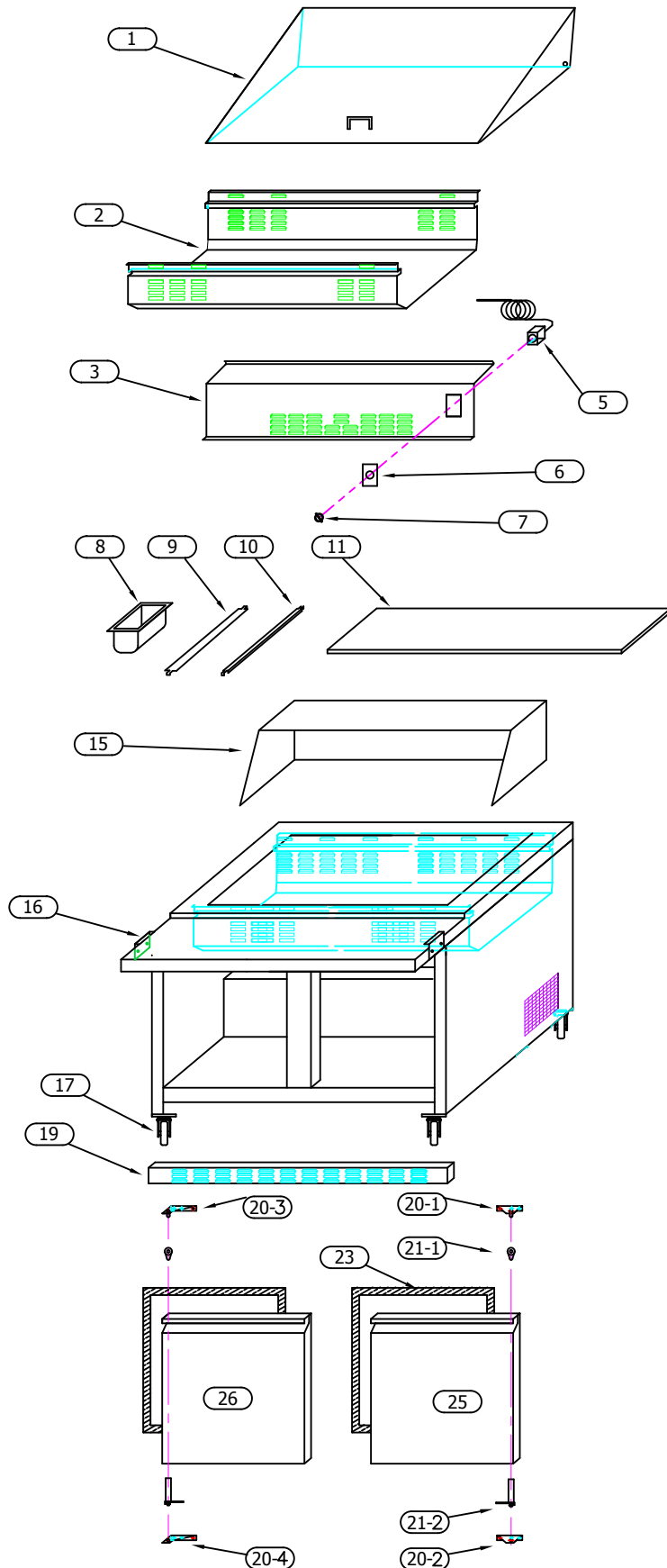

**CABINET ASSEMBLY LIST**

**MODEL: JMP-4818**

**09/08**

No.	Q'ty	Part No. (Use when ordering)	Description	List Price
1	1	453 4232	Top panel, JMP-4818, JMP-7230, 46" wide, (coniment lid)	\$550.00
2	1	453 5701	Panel, food catch, below pans, JMP-4818	\$200.00
3	1	453 1509	Evaporator coil cover, Ascend 48" prep units, inside back panel	\$200.00
5	1	453 7201	Temperature controller, t-stat merchandiser, Ranco	\$90.00
6	1	453 7402	Temperature control (t-stat) metal cover	\$15.00
7	1	453 7401	Temperature control (t-stat) knob	\$10.00
8	18	453 5801	Food pan, polycarbonate, 1/6 size, 4" deep, clear	\$15.00
9	2	453 5809	Pan divider, 3" wide, fits edges, JMP units, each	\$12.00
10	5	453 5808	Pan divider, 1" wide, fits middle sections, JMP units, each	\$8.00
11	1	453 4029	Cutting board, 1/2" x 10" x 47.75"	\$100.00
15	1	453 4523	Hood, JMP-4818, JMP-7230, 46" wide	\$400.00
16	2	453 4015	Bracket, holds cutting board, Ascend preps	\$7.00
17	2	453 4801	Caster, 5", stem, no lock	\$25.00
17	2	453 4802	Caster, 5", stem, with lock	\$30.00
18	1	453 4505	Bottom grill, front, 48" Ascend Preps	\$150.00
20-1	1	453 4301	Hinge, prep & u/c, top right hinge, Ascend units	\$20.00
20-2	1	453 4303	Hinge, prep & u/c, bottom right hinge, Ascend units	\$20.00
21-1	2	453 4121	Plastic / nylon circular bushing insert, top of door	\$5.00
20-3	1	453 4304	Hinge, prep & u/c, top left hinge, Ascend units	\$20.00
20-4	1	453 4306	Hinge, prep & u/c, bottom left hinge, Ascend units	\$20.00
21-2	2	453 4400	Tensioner, bottom of door, prep & u/c	\$38.00
23	2	453 4200	Door gasket, Ascend 48 and 72" prep & u/c	\$60.00
25	1	453 4113	Door, Ascend 48 and 72" prep units, hinge right	\$200.00
26	1	453 4114	Door, Ascend 48 and 72" prep units, hinge right	\$200.00
31	1	453 4514	Bottom back mesh cover, Ascend 48" prep & u/c	\$125.00
33	1	453 6302	Power supply terminal block, 600V, 30A, 4 circuit	\$30.00
34	1	453 3518	Cap tube. 0.052 ID, 48 in.	\$18.00
35	1	453 1701	Accumulator, copper, evap coil	\$25.00
36	1	453 2501	Evaporator drain pan tube, flexible plastic	\$15.00
38	2	453 1204	Evaporator fan motor w/blade, 115V	\$142.00
38		453 1210	Evaporator fan motor w/blade, NMB 120V/1PH/14W	\$142.00
39	1	453 1113	Evaporator coil for 48" Ascend preps, 5d x 25w (4/5)	\$300.00
40	1	453 1601	Drain pan, evaporator, 48" Prep & u/c	\$50.00
41-1	1	453 2401	Condenser fan blade, 5B, 7.75" diameter	\$20.00
41-2	1	453 2302	Condenser fan blade cover / guard, 9" dia.	\$20.00
41-3	1	453 2207	Condenser fan motor, 115V	\$90.00
42	1	453 3601	Filter drier, copper spun	\$20.00
45	1	453 2108	Condenser coil, 48" preps, 9x3.5x8 (8x4)	\$250.00
48-1	1	905 3303	Capacitor for AEA4440YXA (start)	\$40.00

**CABINET ASSEMBLY LIST**

**MODEL: JMP-4818**

**09/08**

No.	Q'ty	Part No. (Use when ordering)		Description	List Price
48-2	1	905	3203	Relay for AEA4440YXA, 1/3 HP	\$30.00
48-3	1	905	3403	Overload for AEA-4440YXA, 1/3 HP	\$40.00
49	1	905	3103	Compressor Tecumseh, 1/3 HP R-134a	\$300.00
50				Condensate pan, w/ hot gas loop, Ascend 48" prep units	
53	2	453	4320	System deck rail, left or right, Ascend prep & u/c	\$15.00
54	1	453	4322	Deck, system, 48" prep & u/c	\$40.00
55	2	453	4316	Cabinet support, 48" prep & u/c	\$40.00
60	2	453	5211	Vinyl coated wire shelf, Ascend 48 & 72" prep & u/c, 21.25" x 17.25"	\$60.00
61	8	453	5104	Pilaster, Ascend prep units	\$15.00
62	8	453	5303	Shelf clip (each)	\$5.00