

CABINET ASSEMBLY

MODEL: JMP-2712

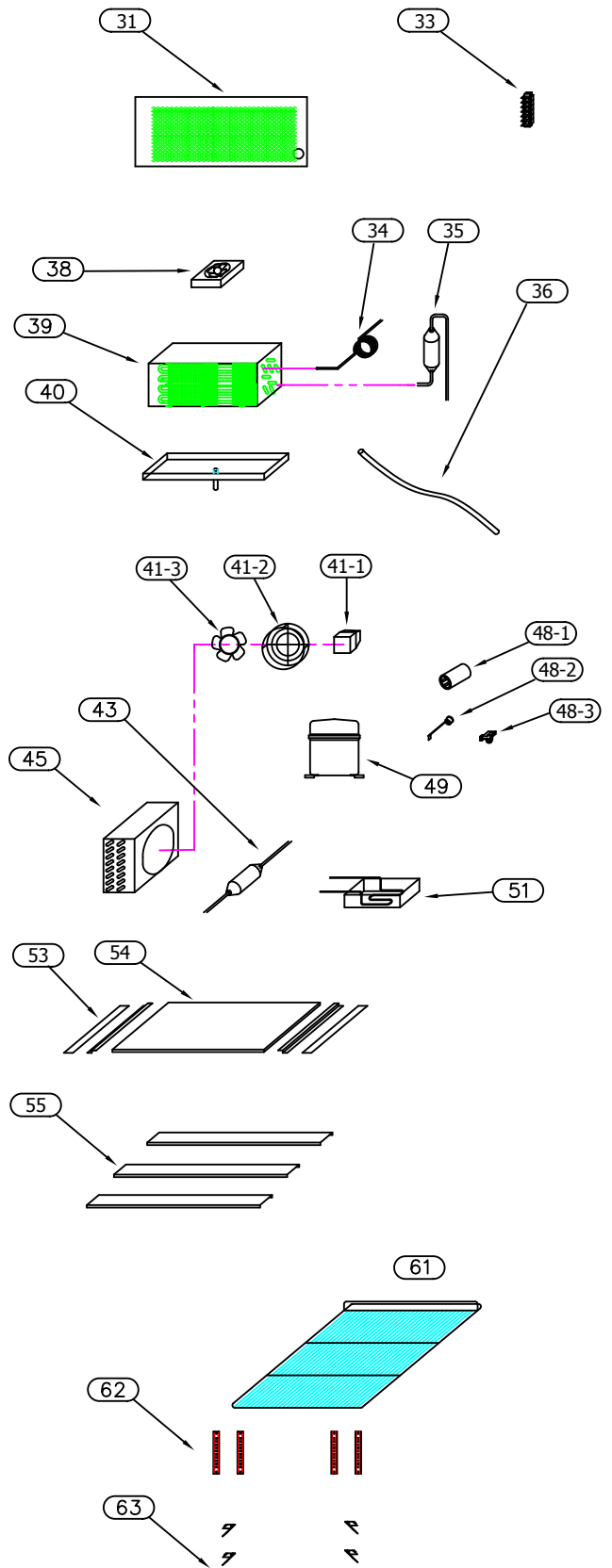
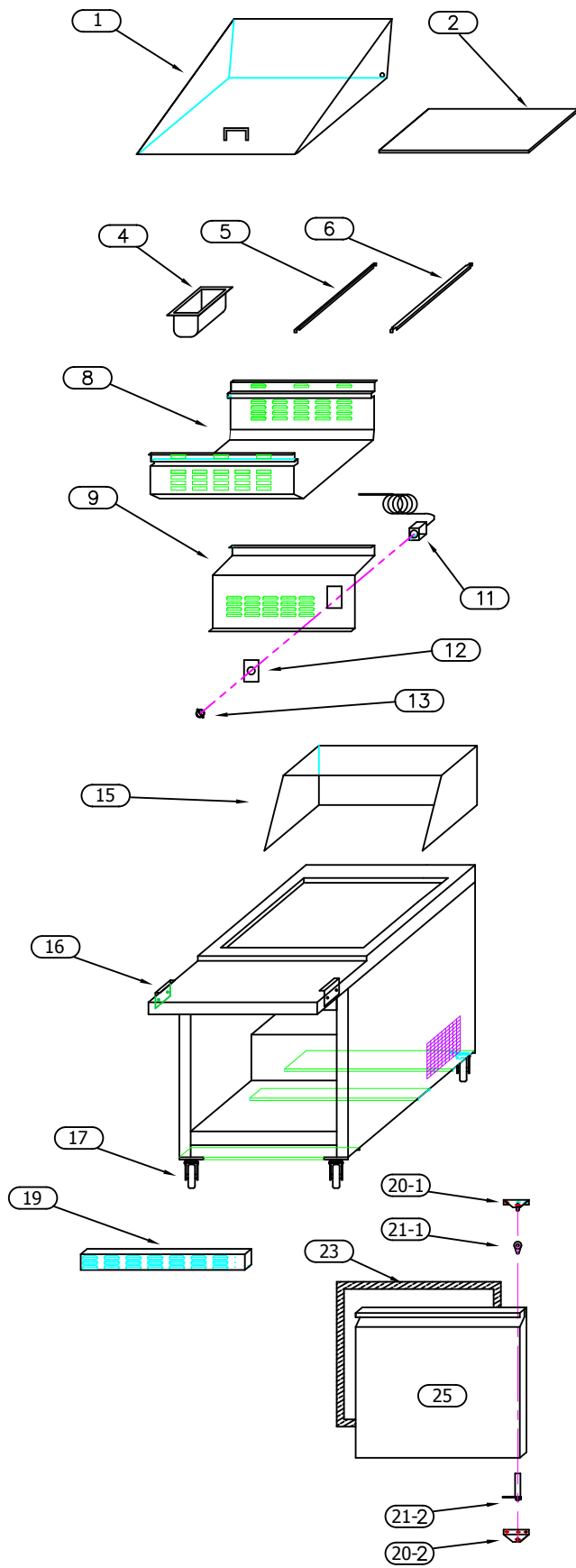

CABINET ASSEMBLY LIST

MODEL: JMP-2712

09/08

No.	Q'ty	Part No. (Use when ordering)		Description	List Price
1	1	451	4231	Top panel, JMP-2712, JMP-7230, 25.5" wide, (coniment lid)	\$350.00
2	1	451	4028	Cutting board, 1/2" x 10" x 27"	\$75.00
4	6	451	5801	Food pan, polycarbonate, 1/6 size, 4" deep, clear	\$15.00
4	2	451	5802	Food pan, polycarbonate, 1/9 size, 4" deep, clear	\$15.00
5	2	451	5807	Pan divider, .5" wide, fits on edges only, JMP units, each	\$8.00
6	3	451	5808	Pan divider, 1" wide, fits middle sections, JMP units, each	\$8.00
8	1	451	5701	Panel, food catch, below pans, JMP-2712	\$150.00
9	1	451	1509	Evaporator coil cover, Ascend 27" prep units, inside back panel	\$150.00
11	1	451	7201	Temperature controller, t-stat merchandiser, Ranco	\$90.00
12	1	451	7402	Temperature control (t-stat) metal cover	\$15.00
13	1	451	7401	Temperature control (t-stat) knob	\$10.00
15	1	451	4522	Hood, JMP-2712, JMP-7230 unit, 25.5" wide	\$200.00
16	2	451	4015	Bracket, holds cutting board, Ascend preps	\$7.00
17	2	451	4801	Caster, 5", stem, no lock	\$25.00
17	2	451	4802	Caster, 5", stem, with lock	\$30.00
19	1	451	4505	Front bottom vent grill, 27"	\$100.00
20-1	1	451	4301	Hinge, prep & u/c, top right hinge, Ascend units	\$20.00
20-2	1	451	4303	Hinge, prep & u/c, bottom right hinge, Ascend units	\$20.00
21-1	1	451	4121	Plastic / nylon circular bushing insert, top of door	\$5.00
21-2	1	451	4400	Tensioner, bottom of door, prep & u/c	\$38.00
23	1	451	4200	Door gasket, 27 and 60" prep units	\$60.00
25	1	451	4113	Door, 27 and 60" prep units, hinge right	\$200.00
31	1	451	4514	Bottom back mesh cover, Ascend 27" prep units	\$100.00
33	1	451	6302	Power supply terminal block, 600V, 30A, 4 circuit	\$30.00
34	1	451	3505	Cap tube. 0.031 ID, 31 in.	\$18.00
35	1	451	1701	Accumulator, copper, evap coil	\$25.00
36	1	451	2501	Evaporator drain pan tube, flexible plastic	\$15.00
38	1	451	1204	Evaporator fan motor w/blade, 115V	\$142.00
38		451	1210	Evaporator fan motor w/blade, NMB 120V/1PH/14W	\$142.00
39	1	451	1112	Evaporator coil for 27" Ascend preps, 5d x 16.25w (4/4)	\$180.00
40	1	451	1601	Drain pan, evaporator, 27" Ascend prep	\$50.00
41-1	1	451	2207	Condenser fan motor, 115V	\$90.00
41-2	1	451	2302	Condenser fan blade cover / guard, 9" dia.	\$20.00
41-3	1	451	2401	Condenser fan blade, 5B, 7.75" diameter	\$20.00
43	1	451	3601	Filter drier, copper spun	\$20.00
45	1	451	2107	Condenser coil, 27" Ascend preps, 9x2.75x8 (6x3)	\$200.00
48-1	1	904	3302	Capacitor for AEA4430YXA (start)	\$40.00
48-2	1	904	3402	Overload for AEA-4430YXA, 1/4 HP	\$40.00
48-3	1	904	3202	Relay for AEA4430YXA, 1/4 HP	\$30.00
49	1	904	3102	Compressor Tecumseh, 1/4 HP R-134a	\$300.00

CABINET ASSEMBLY LIST

MODEL: JMP-2712

09/08

No.	Q'ty	Part No. (Use when ordering)		Description	List Price
51				Condensate pan, w/ hot gas loop, Ascend 27" prep units	
53	2	451	4320	System deck rail, left or right, Ascend prep & u/c	\$15.00
54	1	451	4322	Deck, system, 27" Ascend prep	\$30.00
55	3	451	4316	Cabinet support, 27" Acend prep	\$40.00
61	2	451	5210	Vinyl coated wire shelf, Ascend 27" prep & u/c, 22.75" x 17.25"	\$60.00
62	4	451	5104	Pilaster, Ascend prep units	\$15.00
63	8	451	5303	Shelf clip (each)	\$5.00